



Rendez-Vous

New Jersey 2011



Welcome

Welcome to the 7th Annual
AIRROC/R&Q Commutations
and Networking Event.



Keep this programme with you throughout the event. You should find all the information you need to make your Commutations and Networking event a success.

You will find the timetable on the following pages.

The opening dinner and the event will both be held in the Grand Ballroom on the second floor of the hotel. Breakfasts, snacks and lunches will all be served across the way in the Brunswick rooms. Please see page 12 for the Hilton's floor plans.

We hope all delegates will attend the dinner on the first evening as it is an ideal way for us to meet as many of you as possible before the hard work begins. Please let us know if you do not plan to attend, so we can cater for the correct number of people.

We look forward to seeing you.

Sponsors

The organisers of the AIRROC / R&Q
Commutations & Networking Event would like to thank
the following sponsors for their generous support:



Special thanks to our Media Sponsor – The Insurance Insider



Timetable

Sunday 16 October 2011

11:00am **Golf Event**
Sponsored by Citadel Risk Management

8:00pm - 11:00pm **Pre Event Drinks** - Sports Bar (Concourse Level)
Sponsored by Freeborn & Peters LLP

Monday 17 October 2011

7:30am - 9:30am **Breakfast** - served from Brunswick Rooms
(Ballroom Level)

8:45am - 4:30pm **The Educational Sessions**
Ballroom sections AB (Ballroom Level)
Co chairs of program: Katherine Barker,
Armour Risk Management Inc. &
Jonathan Bank of Locke Lord LLP
5 CLE credits available for attendance
*Sponsored by Mound Cotton Wollan &
Greengrass LLP*

Noon onwards **Registration** - Foyer of Ballroom

Noon - 2:00pm **Welcome Luncheon** - served from Brunswick
Rooms (Ballroom Level)
Speaker: Jonathan Bing,
Deputy Superintendent NYLB
Sponsored by Chadbourne & Parke LLP

4:00pm - 5:30pm **AIRROC Annual Board Members Meeting**
Woodbridge (Ballroom Level)
(all AIRROC members are invited)

6:00pm - 7:30pm **Cocktail Reception** - Foyer of Ballroom

Timetable



Monday 17 October 2011 (continued)

7:30pm - 9:30pm **AIRROC/R&Q Opening Dinner** - Ballroom including 'AIRROC Run-Off Person of the Year' *Sponsored by Sidley Austin LLP*

9:30pm - 11:00pm **After Dinner Drinks** - Sports Bar (Concourse Level) featuring the Rendez-Vous Band *Sponsored by Zurich*

11:00pm onwards **Cash Bar** - Sports Bar (Concourse Level)

Tuesday 18 October 2011

7:30am - 9:30am **Breakfast** - served from Brunswick Rooms (Ballroom Level) *Sponsored by Mayer Brown LLP*

7:30am - 5:00pm **Commutation Negotiations/Networking** Ballroom

Noon - 2:00pm **Lunch** - Served from Brunswick Rooms (Ballroom Level) *Sponsored by Locke Lord LLP*

Noon - 2:00pm **AIRROC Women's Networking Luncheon** Trenton & Monroe (Concourse Level) (not for women only) Moderator: Trish Getty Key Note Speaker: Karen Weldin-Stewart, Insurance Commissioner, State of Delaware Ins Dept *Sponsored by Edwards Wildman Palmer LLP*

5:30pm - 8:00pm **KPMG Cocktail Reception** Tower 2 Atrium

8:00pm onwards **Cash Bar** - Sports Bar (Concourse Level)

Wednesday 19 October 2011

7:30am - 9:30am **Breakfast** - served from Brunswick Rooms (Ballroom Level) *Sponsored by Barger & Wolen LLP*

7:30am - 5:00pm **Commutation Negotiations/Networking** Ballroom

Noon - 2:00pm **Lunch** - served from Brunswick Rooms (Ballroom Level) *Sponsored by Foley & Lardner LLP*

Educational Sessions:

For more details on topics & speakers at the Educational Sessions, please refer to page 8.

Dress Code:

For the evening dinner is business formal and during the rest of the event is business casual.

Educational sessions



Monday 17 October 2011

8:45am Welcome and Opening Remarks

Conference Chairs:

Jonathan Bank, Locke Lord LLP

Kathy Barker, President, Armour Risk Mgmt Inc

9:00am Part VII Transfer - The Practical Guide

Moderator:

Steve Goodlud, Director, KPMG LLP

Speakers:

Nigel Montgomery, Partner, Sidley Austin LLP UK

Ken Wylie, Partner, Sidley Austin LLP USA

Stuart Shepley, Partner, KPMG LLP

Tom Taylor, Head of Transaction Management,
AXA Liabilities Managers

Jim Moran, Director, RQLM

10:15am Break

10:30am Run-offs - The Sane Alternative to Traditional Receiverships? (The Changing Face of Run-off Legislation)

Moderator:

Norris Clark, Financial & Regulatory Specialist,
Locke Lord LLP

Speakers:

Stephen J Johnson, CPA, Deputy Insurance Commissioner,
Pennsylvania Insurance Dept

Robert Kasinow, Assistant Commissioner,
New Jersey Banking & Insurance Dept

Joseph Fritsch, Deputy Superintendent for Accounting &
International Affairs, NY Insurance Dept

Karen Weldin-Stewart, Insurance Commissioner,
State of Delaware Dept of Insurance

Steven Anderson, Managing Partner, Barger & Wolen LLP

Noon Lunch

1:00pm Industry Leader Forum - Senior Executives on the challenges of managing the assets and liabilities of discontinued operations

Moderator:

Lloyd Gura, Partner, Mound Cotton Wollan & Greengrass LLP

Speakers:

Norbert Lommer, Global Head of Finance,
Global Discontinued Business Division,
Allianz Life Insurance Company

Scott Belden, M.D. Risk & Reinsurance,
Travelers Insurance Companies

Mindy Kipness, SVP, Chartis Global Reinsurance Division

Pat Fee, President, Hannover Finance Inc

Steve Agosta, SVP & General Counsel,
XL Reinsurance America Inc

2:45pm Break

3:00pm The Great Debate - Your Vote Counts

Speakers:

Eric Haab, Partner, Foley & Lardner LLP

Joe McCullough, Partner, Freeborn & Peters LLP

Mary Lopatto, Partner, Chadbourne & Parke LLP

Francis Mackie, Partner, Edwards Wildman Palmer LLP

Brian O'Sullivan, Partner, Mayer Brown LLP

4.15pm Closing Remarks / Wrap Up

Speakers:

James Veach, Partner, Mound Cotton Wollan
& Greengrass LLP

Lawrence Greengrass, Partner, Mound Cotton Wollan
& Greengrass LLP

4:30pm Adjourn



The Hilton

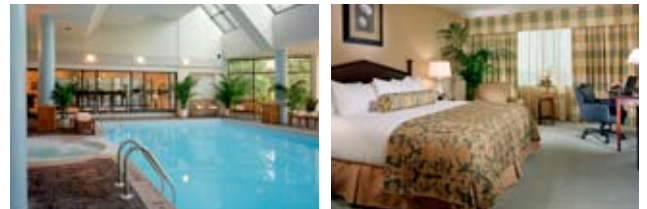

Leave the hectic commuter world behind and enter a refined centre of calm - the **Hilton East Brunswick** in lively East Brunswick, New Jersey. Experience the modern charm of the wireless lobby filled with lovely gardens and lavish fountains. Conference facilities boast 26,000 square feet of meeting space. Dine at one of the three inviting establishments. Take a dip in the pool or work out in the fitness centre. The Hilton East Brunswick is the perfect place for discerning business and leisure travellers.

Conference Centre Floor Plans

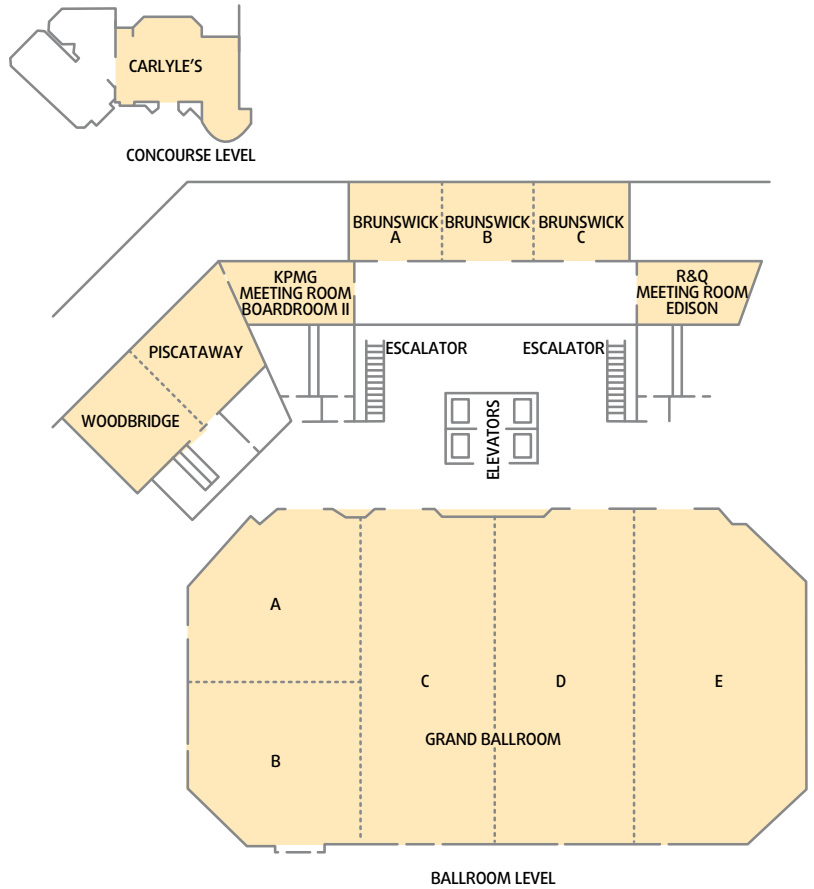
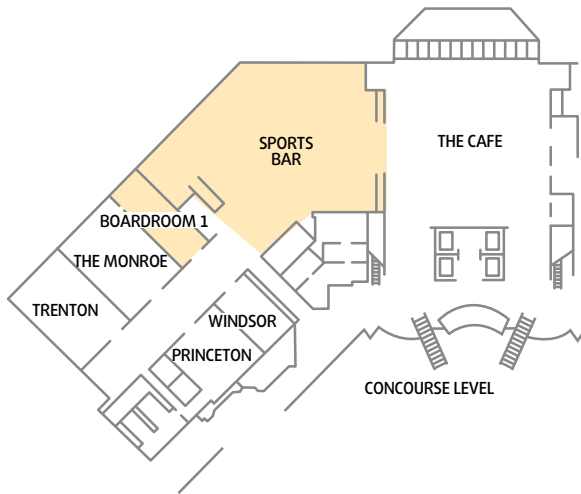



Directions

From NJ Turnpike North or South: Exit 9 of NJ Turnpike through the toll plaza, bear right towards Route 18 North and take the first right into the complex, go straight to the traffic light. At the traffic light, make a left onto Tower Center Boulevard - the Hilton East Brunswick is at the end of the drive.

Airport to hotel

Newark International Airport

Directions from Newark International Airport - Take NJ Turnpike South to Exit 9 on 18 North.

Distance from hotel: 20 miles, drive time: 30 minutes.

Transportation

Bus Service	Call hotel for information
Limousine	\$70.00
Rental Car	Rates Vary
Taxi	\$70.00

JFK International Airport

Directions from JFK International Airport - Belt Parkway to Verrazzano Bridge to Goethals Bridge to NJ Turnpike south to Exit 9.

Distance from hotel: 60 miles, drive time: 1.5 hours.

Transportation

Limousine	\$160.00
Rental Car	Rates Vary
Taxi	\$160.00

La Guardia Airport

Directions from La Guardia Airport - Brooklyn Queens Expressway (BQE) to Verrazzano Bridge to Goethals Bridge to NJ Turnpike South to Exit 9.

Distance from hotel: 40 miles, drive time: 1.5 hours.

Transportation

Limousine	\$160.00
Rental Car	Rates Vary
Taxi	\$160.00

Hotel parking

Self Parking	\$8.00
Valet Parking	\$14.00
In/Out Privileges	Available
Secured	Available
Covered	Available

Car Services

Local service ranges from	\$12 - \$40
Airport service ranges from	\$75 & Up
(Prices are subject to change. Please call to verify)	

First Class Limousine Service (Van service available)	1-866-352-5277
Golden Class Limo (Alex)	1-732-322-3386
A&M Limo (Jorge)	1-732-718-0460
Jad's Limo Service (Kaado)	1-732-236-5610

Taxi Services

Triple A	1-732-416-1616
Victory Cabs	1-732-545-6666

Restaurants

Italian

PANICO'S t (732) 545-6100

Church Street, New Brunswick, 08901
www.panicosrestaurant.com

Directions: 2.4 miles from The Hilton. At the second traffic light make a right onto 18 North. Take exit for 27 South, stay straight off ramp. Make the first left onto Neilson. Make your first right onto Church Street. Restaurant is on the right side.

Continental

THE FROG & THE PEACH t (732) 846-3216

Dennis Street, New Brunswick, 08901-1206
www.frogandpeach.com

Directions: 2.5 miles from The Hilton. At second light make a right onto 18 North. Take exit for 27 South, stay straight off ramp. Make first left onto Neilson Street. Pass Hyatt and make a left into Hyram Square. At end make a right onto Dennis Street. Restaurant will be on your right.

CLYDE'S t (732) 846-6521

Paterson Street, New Brunswick, 08901-2296
www.clydz.com

Directions: 3 miles from The Hilton. At second light make a right onto 18 North. Take exit for 27 South, stay straight off ramp. Make second left onto George Street. Stay straight at 3 way intersection. Make right onto Bayard Street. Make a left at the stop sign & then left onto Paterson. Restaurant is on the left side.

OLD BAY t (732) 246-3111

61-63 Church Steet, New Brunswick, 08901-1242
www.oldbayrest.com

Directions: 2.6 miles from The Hilton. At the second light make a right onto 18 North. Take exit for 27 South, stay straight off the ramp. Make first left onto Neilson Street. Restaurant is on 1st corner, directly across from Hyatt.



OUTBACK STEAKHOUSE t (732) 819-0990

Route 1 South, Edison, 08817-4481
www.outback.com

Directions: 2.9 miles from The Hilton. At the second light make a right onto 18 North. Take exit for Route 1 North. Follow Route 1 approximately 3 miles. Restaurant will be on the corner of Route 1 and Plainfield Avenue. Take U-Turn around Mack Truck Dealer.

HARVEST MOON BREWERY & CAFE t (732) 249-6666

392 George St, New Brunswick, 08901-2018
www.harvestmoonbrewery.com

Directions: 2.7 miles from The Hilton. At second light make a right onto 18 North. Take exit for 27 South, stay straight off ramp. Make a left at second traffic light, a right at the first corner and make a right at the first light onto George Street.

Southern Cuisine

DELTA'S t (732) 249-1551

Dennis Street, New Brunswick, 08901-1206
www.deltasrestaurant.com

Directions: 2.5 miles from The Hilton. At the second light make a right onto 18 North. Take route 18 north to New street exit. Take the jug handle around to the first traffic light and make a right (Neilson street). Take the next right onto Richmond street. Take the next left onto Dennis street. Restaurant is on the right.

Restaurants



Mexican

JOSE TEJAS t (732) 283-3883

Route 1 North, Woodbridge, 08830-2631

Directions: 8.9 miles from The Hilton. At the second traffic light make a right onto 18 North. Take Exit for Route 1 North. Follow Route 1 approximately 5 miles and restaurant will be on right hand side. *Very Popular, wait could be up to 1 hour.

ON THE BORDER t (732) 979-2192

Route 1 South, New Brunswick, 0801
www.ontheborder.com

Directions: 1.2 miles from The Hilton. At the second light make a right onto 18 North. Take exit for Route one South. Follow Route 1 South approximately 2 miles. Restaurant will be on your right.

Asian

SUNNY PALACE t (732) 651-8668

Route 18, East Brunswick, 08816-4351
www.sunnypalace.com

Directions: 4.6 miles from The Hilton. At second light make a left onto 18 South. Follow 18 approximately 3 miles. Restaurant will be on right side.

SHOGUN 18 t (732) 390-1922

Route 18 North, East Brunswick, 08816-4354
www.shogun18.net

Directions: 5.1 miles from The Hilton. At second light make a left onto 18 South. Follow 18 approximately 7 miles. Restaurant will be in shopping center on North Side. Take first U-Turn and restaurant will be on your right.

WASABI HOUSE JAPANESE CUISINE t (732) 254-9988

77 Tices Lane East Brunswick, NJ 08816-2191

Directions: 2 miles from The Hilton. At second light make a left turn onto 18 South. Turn right on Tices Lane. Approximately 3 to 5 minutes.

Lebanese

EVELYN'S RESTAURANT & BAR t (732) 246-8792

Easton Avenue, New Brunswick, 08901-1830
www.evelynsrestaurant.com

Directions: 3 miles from The Hilton. At second light make a right onto 18 North. Take exit for 27 South, stay straight off ramp. After train station make the right onto Easton Avenue. Past one light, restaurant is on the right.

Ethiopian

MAKEDA ETHIOPIAN RESTAURANT t (732) 545-5115

George Street, New Brunswick, 08901-2011
www.makedas.com

Directions: 2.5 miles from The Hilton. At second light make a right onto 18 North. Take exit for 27 South, stay straight off ramp. Make second left onto George Street. Restaurant will be on right.



www.rqih.com

UK Offices

Head Office

110 Fenchurch Street,
London EC3M 5JT

Grove House,
Newland Street, Witham,
Essex, CM8 2UP

Evolution House, Unit C/D
Iceni Court, Delft Way,
Norwich, NR6 6BB

US Offices

101 Summer Street,
5th Floor,
Boston MA 02110

United Plaza,
30 South 17th Street, Suite 715,
Philadelphia PA 19103

Bermuda Office

FB Perry Building,
40 Church Street, PO Box
HM 2062, Hamilton
HM HX Bermuda

For further information or to discuss any of our services contact:

Alan Quilter +44 (0) 20 7481 1010 alan.quilter@rqih.com

John Dewen +44 (0) 20 7977 0800 john.dewen@rqih.com



Global Resource Managers, 1249 So. River Road, Cranbury, NJ 08512-3603

t +1 (609) 395 3497 **e** edward.gibney@cna.com

www.airroc.org